

(Stainless Steel Pump)



### Product features:

1. Adopting High efficiency motor which conforms to Insulation Class F and Protection IP54.
2. Durable mechanical seal prevents from leakage and keeps long life.
3. Compact & robust structure for saving space and for easy installation.
4. Special volute design for low noise operation and great performance.
5. The motor and pump is coaxial conjoined. This will cancel out the fluctuations which will save energy and resources.

### Applications:

- Air conditioning systems
- Broad range of industrial applications
- Temporary water supply booster systems
- Open loop and close loop water circuit systems
- Water supply and disposal for households

### Operating conditions:

- Ambient temperature: Up to 50°C
- Liquid temperature: Up to 60°C
- For clean liquids, without solid, filamentary or abrasive matter
- Working pressure: Max. 10 bar
- Motor voltage: Three-phase 220/440V;380/660V (50Hz/60Hz)

### Structure drawing:

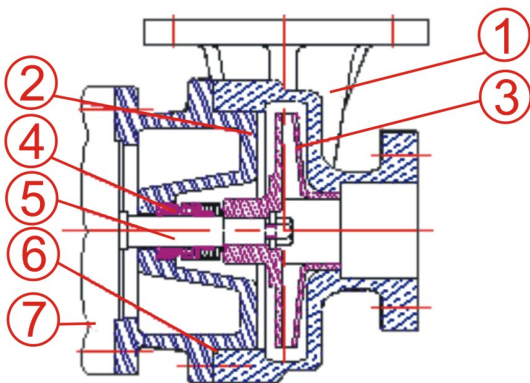

No.	Part name	Standard Material	Available Material
1	Pump casing	FC200	SUS304 SUS316
2	Back plate	FC200	SUS304 SUS316
3	Impeller	BC6	SUS304 SUS316
4	Mechanical seal	NBR+SIC+C	Viton/Tc
5	Shaft	SUS410	SUS304
6	Casing gasket	NBR	-----
7	Motor	FC200	-----

### Model code:

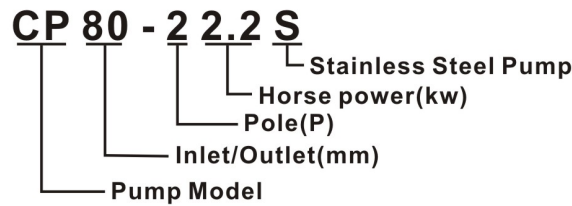

### Performance curves(2P,2900R.P.M,50Hz)

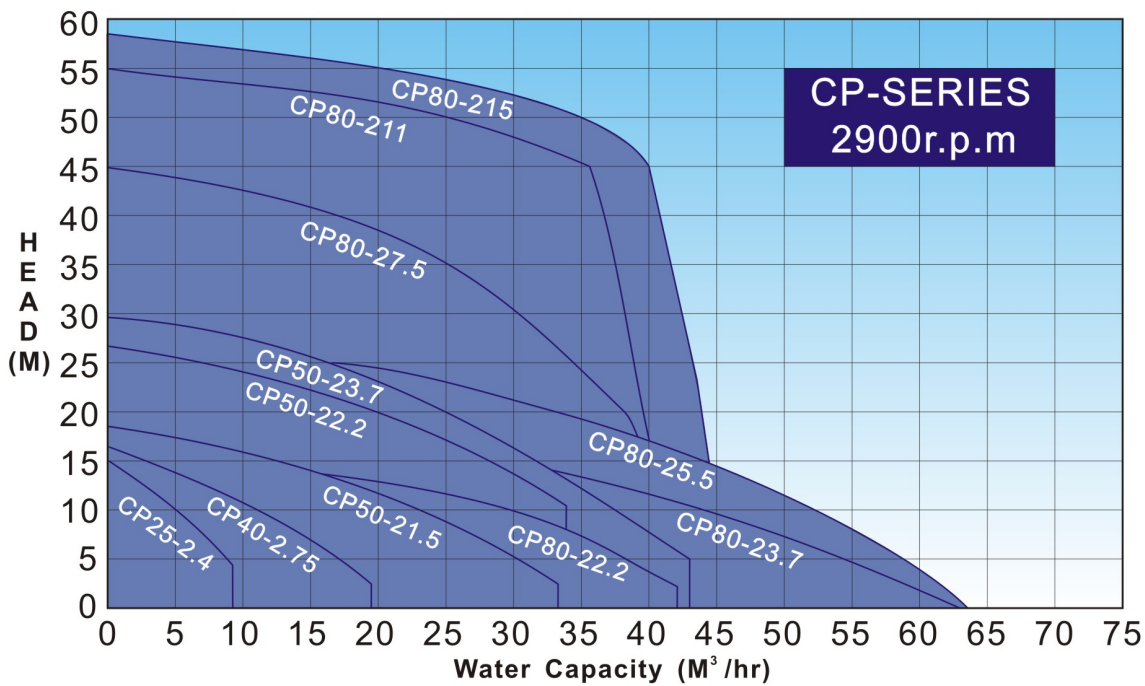

### Specification (2P,3Ø,2900R.P.M,50Hz)

Model	Power KW	Inlet mm	Outlet mm	Rated Head / Rated Capacity						Max.Head M	Max.Flow M³/hr
				M	M³/hr	M	M³/hr	M	M³/hr		
CP25-2.4	0.37	25	25	8	6	10	5.2	12	4.5	15	8
CP40-2.75	0.75	40	40	9	13.5	11	11	13	8.0	16	19.5
CP50-21.5	1.5	40/50	40/50	11	22	13	18.5	15	14.5	17	33
CP50-22.2	2.2	50	50	16	27	20	19.5	24	9.8	26	34.5
CP80-22.2	2.2	65/80	65/80	8	33	10	30	13	22	15	43.5
CP50-23.7	3.7	50	50	18	28	22	22	25	16.5	29.5	43.5
CP80-23.7	3.7	65/80	65/80	10	43.5	14	32	16	23	19.5	63.5
CP80-25.5	5.5	65/80	65/80	15	44.5	18	39.5	22	28.5	26.5	63.5
CP80-27.5	7.5	50/65/80	50/65/80	25	35	35	25	40	18	46	43.5
CP80-211	11	50/65/80	50/65/80	30	38	40	37	45	35	55	43.5
CP80-215	15	50/65/80	50/65/80	35	41	45	40	50	34	58.5	43.5

### Performance curves(4P,1450R.P.M,50Hz)

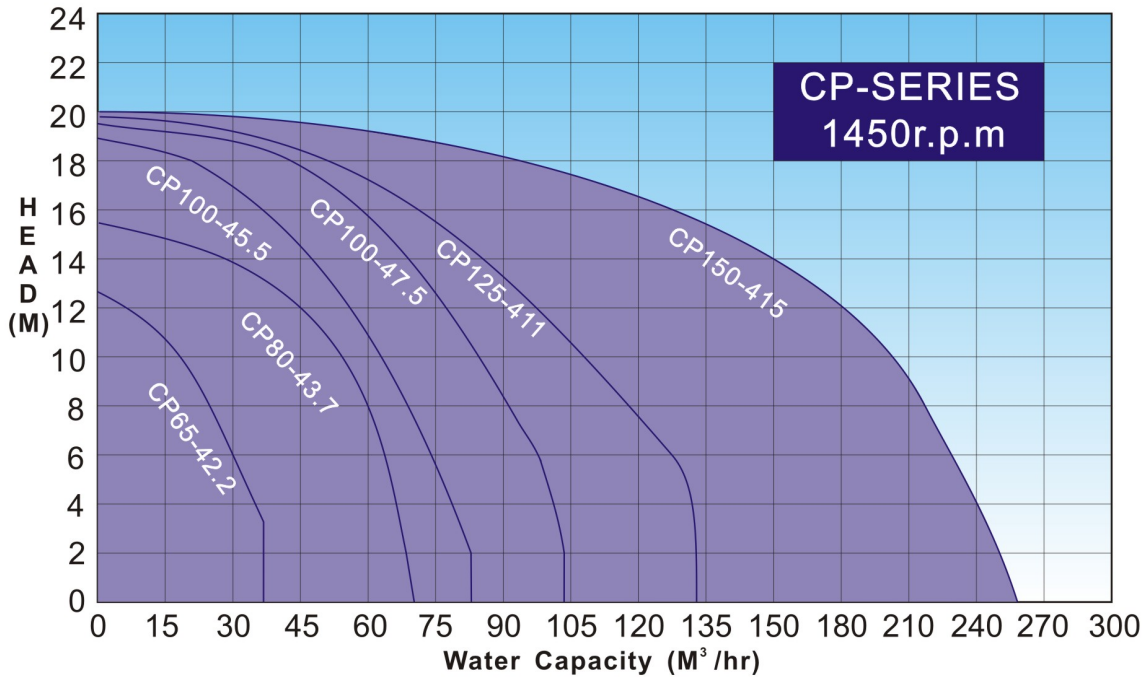

### Specification (4P,3Ø,1450R.P.M,50Hz)

Model	Power	Inlet mm	Outlet mm	Rated Head / Rated Capacity				Max.Head M	Max.Flow M³/hr		
	KW			M	M³/hr	M	M³/hr				
CP65-42.2	2.2	65/80	65/80	6	33.8	8	29.7	10	23	12.5	35
CP80-43.7	3.7	65/80	65/80	8	59	10	52	12	44	15.5	73
CP100-45.5	5.5	100	100	12	56	15	43.5	17	29	19	85
CP100-47.5	7.5	100	100	12	76.5	16	58	18	44	20	103
CP125-411	11	125	125	12	96.5	15	78	17	62	19.5	135
CP150-415	15	150	150	12	180	14	152	16	130	19.5	255

### CP Dimensions

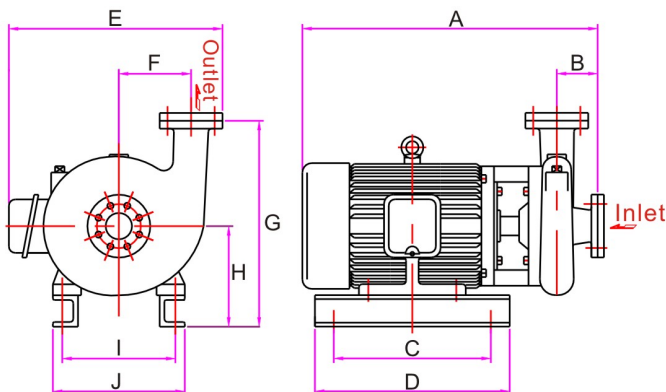

#### (2P,2900R.P.M,50Hz)

Model	A	B	C	D	E	F	G	H	I	J	Weight
CP25-2.4	335	45	205	230	243	65	181	86	112	146	20kg
CP40-2.75	348	45	205	230	264	70	220	95	125	160	25kg
CP50-21.5	408	62	238	260	306	82	242	105	140	175	36kg
CP50-22.2	395	49	238	260	319	95	265	115	140	175	43kg
CP80-22.2	411	59	238	260	319	80	265	105	140	175	43kg
CP50-23.7	481	74	265	300	355	100	297	142	190	240	68kg
CP80-23.7	481	76	265	300	355	100	297	142	190	240	68kg
CP80-25.5	523	73	265	300	388	100	320	162	216	266	90kg
CP80-27.5	559	81	265	300	429	120	327	162	216	266	108kg
CP80-211	676	81	350	400	508	140	410	230	254	308	150kg
CP80-215	676	81	350	400	508	140	410	230	254	308	170kg

#### (4P,1450R.P.M,50Hz)

Model	A	B	C	D	E	F	G	H	I	J	Weight
CP65-42.2	447	64.5	250	300	415	150	320	170	160	205	59kg
CP80-43.7	488	81	250	300	423	140	362	182	190	235	87kg
CP100-45.5	579	104	250	300	473	155	425	202	216	260	115kg
CP100-47.5	617	104	250	300	473	155	425	202	216	260	128kg
CP125-411	696	97	350	400	555	155	458	230	254	308	185kg
CP150-415	775	121	350	400	588	173	470	230	254	308	220kg